

YDL-L

LED YARD LIGHT

The YDL-L is an energy efficient dusk to dawn yard light. It is a versatile and economic light source that is environmentally friendly and uses long life LED's. The YDL-L comes standard with photocontrol which helps to provide significant power savings. It includes an installation bracket for pole and wall mounting and a 21" arm for ease and versatility of installation. All units come standard with 6 feet of power cable.

FEATURES AND SPECIFICATIONS

• Construction

Housing

Die cast aluminum housing with heat sink design for efficient thermal management, finished standard in a silver grey powder coat anti-corrosive finish.

Mounting options

The YDL-L comes standard with a removable 21" aluminum arm for pole or wall mounting.

Lens

Polycarbonate diffused lens encloses high performance CREE COB LEDs for even illumination through a type V distribution pattern.

• Electrical

- Comes standard with 120-277V 50/60Hz non-dimming driver with onboard 3.75KV surge protection
- 6 feet of power cable is included to facilitate the connection to the junction box when mounting with the 21" pole arm
- Twist-lock black photocell 120V included
- Ambient operating temperature range of -40°C to +40°C

• Compliances

- DLC 4.4
- cULus wet location

DIMENSIONS

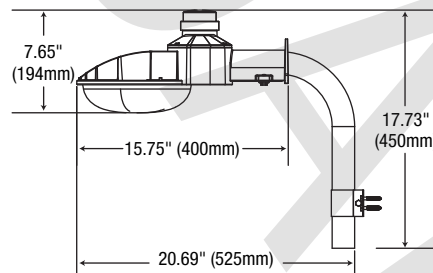
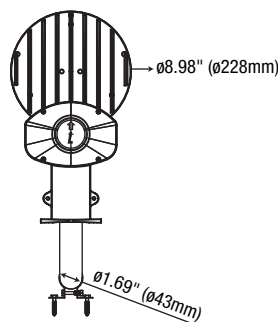

INCLUDED: 21" POLE ARM



Project: _____
 Type: _____
 Catalogue #: _____
 Drawn by: _____
 Date: _____



Not all products are qualified on the DLC QPL. To view our DLC qualified products, please consult the DLC Qualified Products List at www.designlights.org/search.

OVERVIEW

Lamp	LED
Wattage	70W
Lumens	6801lm
Lm/W	97lm/W
Colour temperature	4000K
EPA	0.401 ft²

* Please consult the liquidation page for applicable configurations

QUICK SHIP ORDERING GUIDE ☰*

Part number	Wattage (W)	Lumens	Voltage (V)	Colour temperature	Efficacy (Lm/W)
YDL-LS2-A/40KPT120	70	6801	120	4000K	97

* **QUICK SHIP:** Product availability is subject to change without notice. Please contact your Stanpro customer service representative to confirm inventory levels at time of order.

PHOTOMETRIC DATA

YDL-LS2-A/50KPT120 • 7286 lm

Polar candela distribution

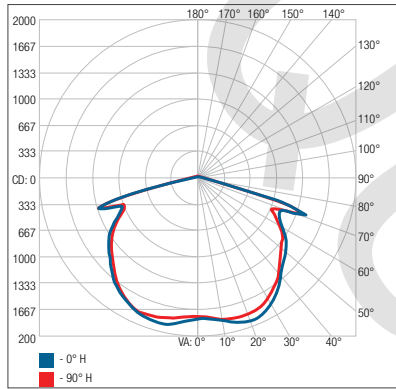

Zonal lumen summary

Zone	Lumens %	Lamp %	% Fixture
0-30	1553.7	21.3%	21.3%
0-40	2625.8	36.1%	36.1%
0-60	5000.4	68.7%	68.7%
60-90	2143	29.4%	29.4%
70-100	1078.6	14.8%	14.8%
90-120	87.2	1.2%	1.2%
0-90	7143.4	98.1%	98.1%
90-180	139.9	1.9%	1.9%
0-180	7283.3	100%	100%

Illuminance at a distance

Center beam fc	Beam width		
4.0'	112 fc	29.3'	27.9'
8.0'	28.1 fc	58.5'	55.8'
12.0'	12.5 fc	87.8'	83.7'
16.0'	7.02 fc	117.1'	111.7'
20.0'	4.49 fc	146.3'	139.6'
24.0'	3.12 fc	175.6'	167.5'

■ Vert. spread: 149.4°
■ Horiz. spread: 148.0°

Comments

* Please consult the liquidation page for applicable configurations

All products are subject to change or may be discontinued any time without notice.